

REVISION HISTORY		
REV	DESCRIPTION	Drawing DATE
B	增加卡扣及修改尺寸形状	Allen 2021/02/25

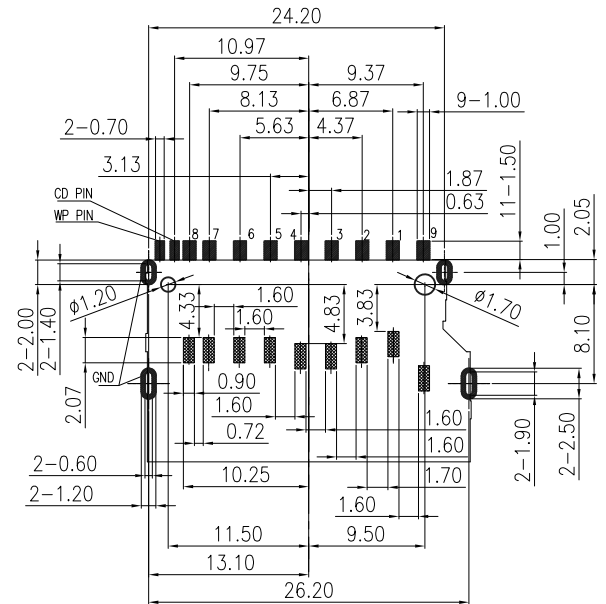

RECOMMENDED PCB LAYOUT (TOP VIEW)
 ALL TOLERANCE ±0.05
 ▨ PAD AREA
 ▩ NO COPPER AREA (NO Trace&Via&GND)

- NOTE:
- MATERIAL:
 - 1.1 INSULATOR: LCP, UL94 V-0, BLACK
 - 1.2 CONTACT: C5191
 - 1.3 SHELL: C2680
 - FINISH:
 - 2.1 TERMINAL: 50u" MIN. NICKEL PLATED OVERALL
 - 2.2 CONTACT: GOLD FLASH
 - 2.3 TAIL: 100u" MATT-TIN PLATED
 - 2.4 SHELL: 30u" MIN. NICKEL PLATED OVERALL
 - PRODUCT SPECIFICATION REFER TO SP-A0520-01
 - PACKAGE DRAWING REFER TO PA0520-01
 - PRODUCT MUST CONFORM TO RoHS AND HALOGEN FREE REQUIREMENT

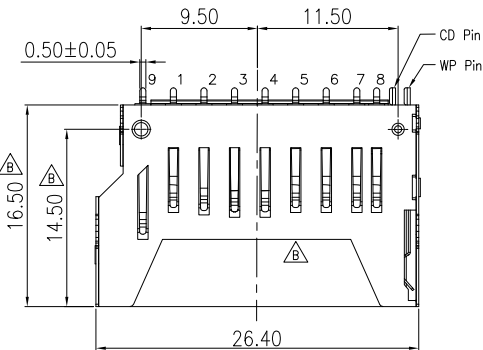
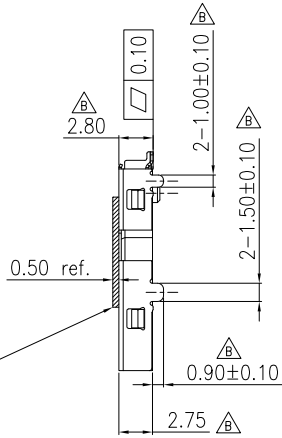
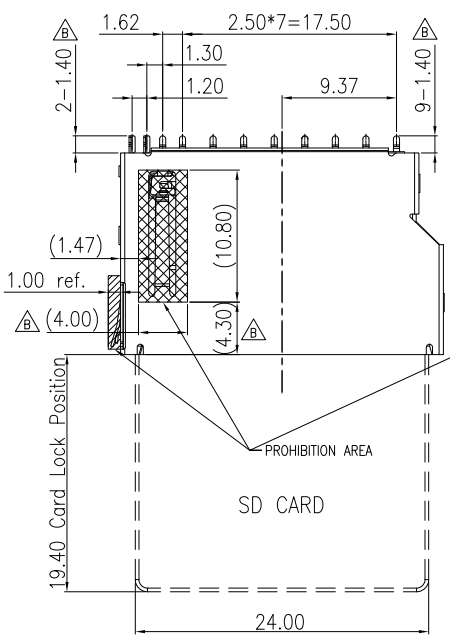
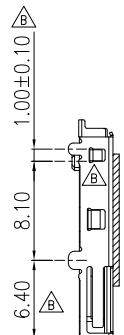
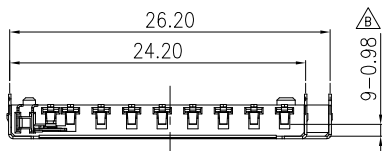
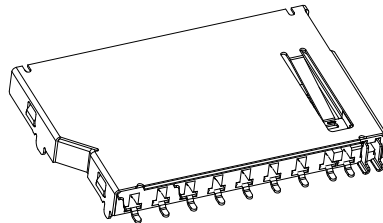
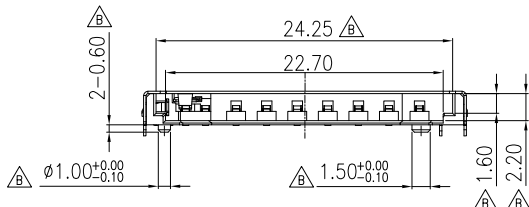

Pin No.	PIN DEFINE
1#	CD/DAT3
2#	CMD
3#	VSS1
4#	VDD
5#	CLK
6#	VSS2
7#	DAT0
8#	DAT1
9#	DAT2

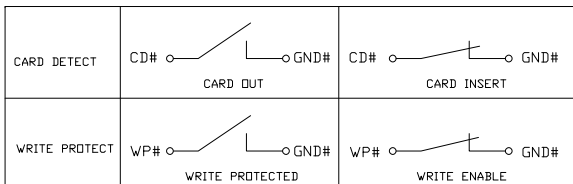

PRODUCT SPECIFICATION: DOC.No: SP-XXXX-XX	SCALE 1 : 1	DESIGN UNITS mm	TITLE FULLINHOPE Technology, LTD. SD CARD, PUSH/PULL DIP TYPE, SHORT BODY
TEST REPORT DOC.No: TR-XXXX-XX	DRAWN Mei Chen	DATE 2017/10/23	
GENERAL TOLERANCES (UNLESS SPECIFIED)	CHECKED	DATE	
X.XXX ± 0.20			
X.XX ± 0.20			
X.X ± 0.25	APPROVED	DATE	
ANGULAR ± 3°			
THIRD ANGLE PROJECTION	DWG NO. SA0520-001	PART NO. A0520-0001	DWG REV. B
			SHEET NO. 1 OF 1

REVISION HISTORY			
REV	DESCRIPTION	Drawing	DATE
A	RELEASE	Sandy	2018/01/24

INPUT MATERIAL DIRECTION →

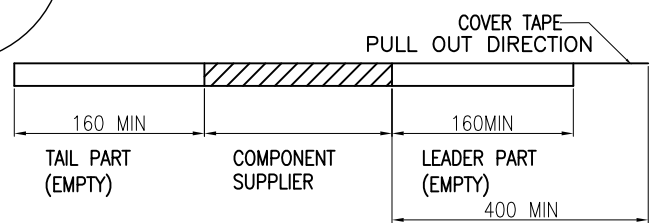
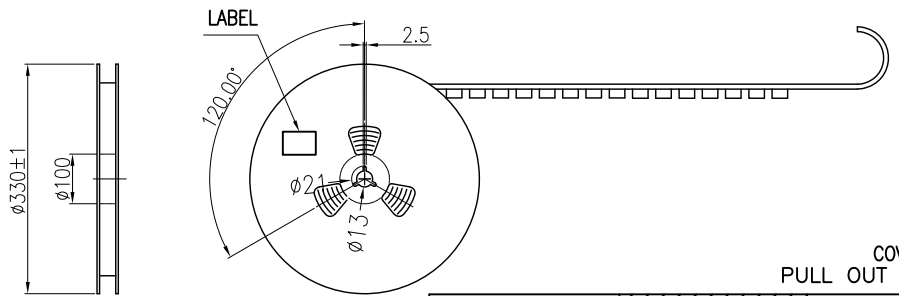
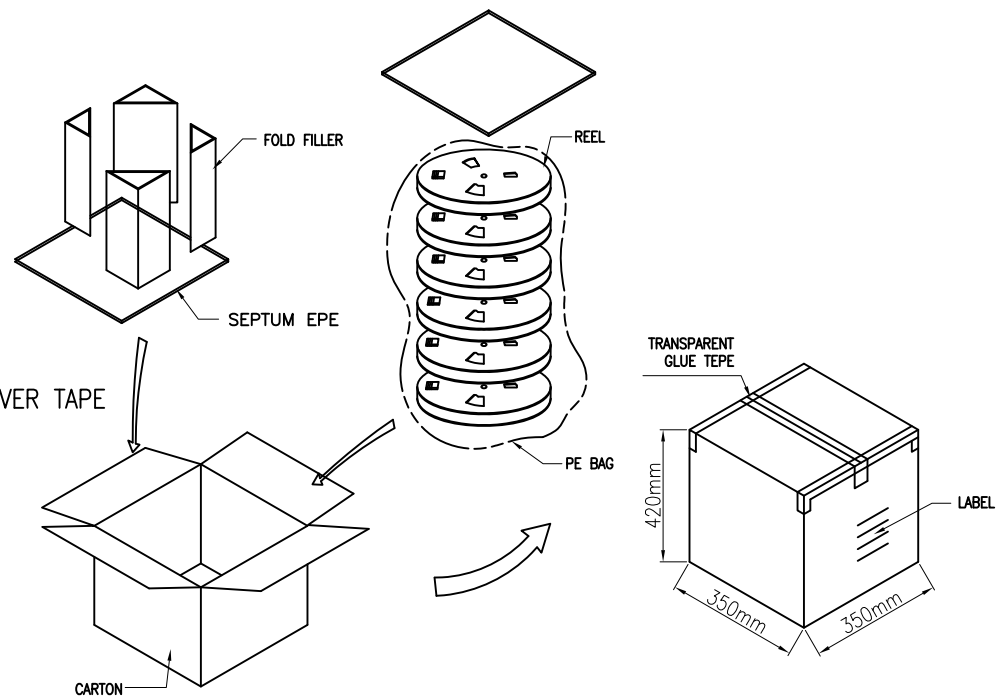
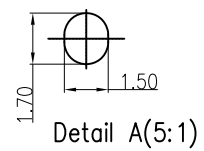
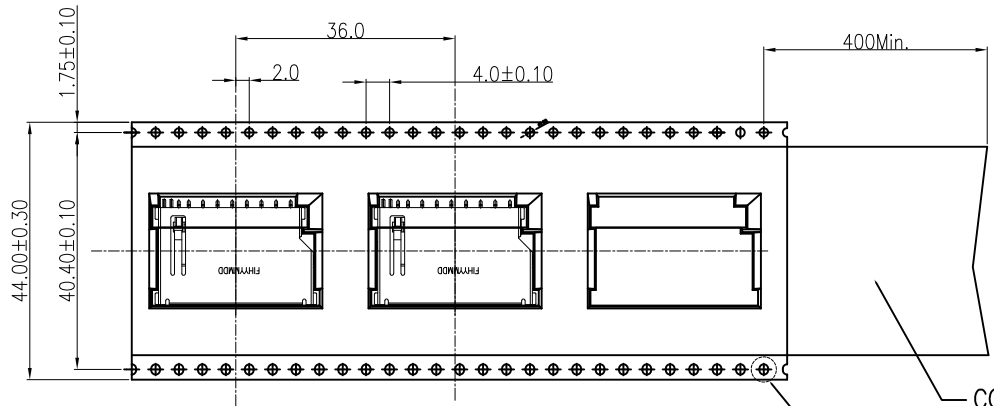

1. COVER TAPE PEELING FORCE:

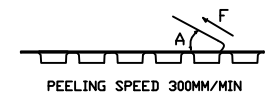

A	15°~ 0°
F	0.1N~1.3N

2. PART DIMENSIONS MEET EIA-481-2-A REQUIREMENT

TABLE

PRODUCT P/N	PARTS PER SHIPPING CARTON	PARTS PER REEL	LOADED REEL PER SHIPPING CARTON
A0520-0001	2700	450	6

PRODUCT SPECIFICATION: DOC.No. SP-A0000-001	SCALE 1 : 1	DESIGN UNITS mm	FULLINHOPE Technology, LTD.	
TEST REPORT DOC.No. TR-A0000-001	DRAWN Mei Chen	DATE 2017/10/23	TITLE SD CARD, PUSH/PULL DIP TYPE, SHORT BODY	
GENERAL TOLERANCES (UNLESS SPECIFIED)	CHECKED	DATE		
X.XXX ± 0.20	APPROVED	DATE		
X.XX ± 0.20				
X.X ± 0.25				
ANGULAR ± 3°				
THIRD ANGLE PROJECTION	DWG NO. PA0520-001	PART NO. A0520-0001	DWG REV. A	SHEET NO. 1 OF 1