

REVISION HISTORY			
REV	DESCRIPTION	Drawing	DATE
08	修改形状	Allen	2021/02/26

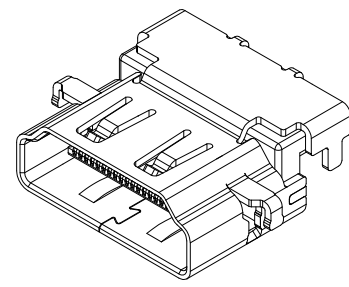
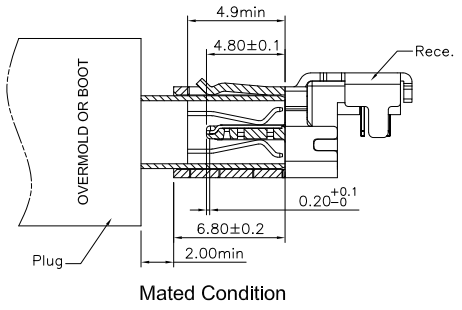
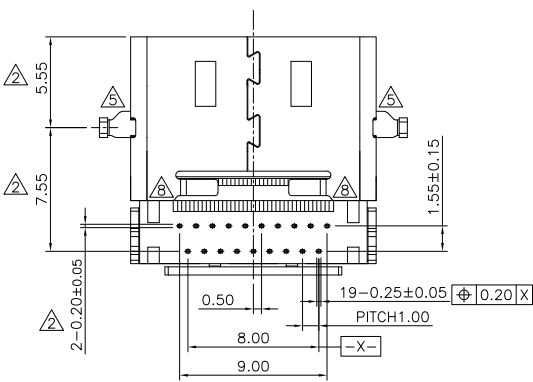
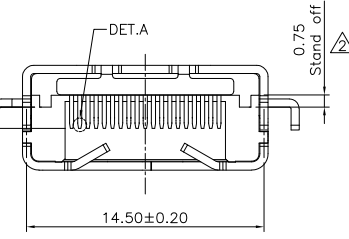
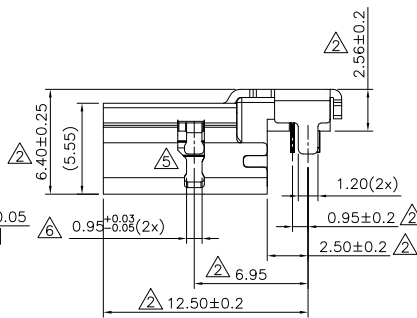
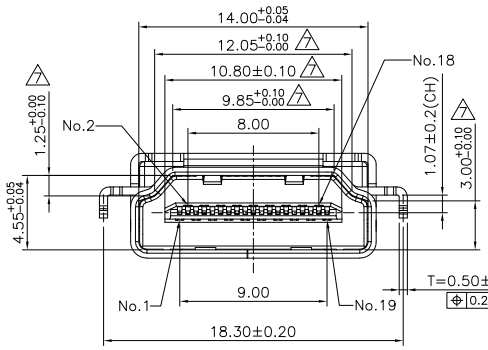
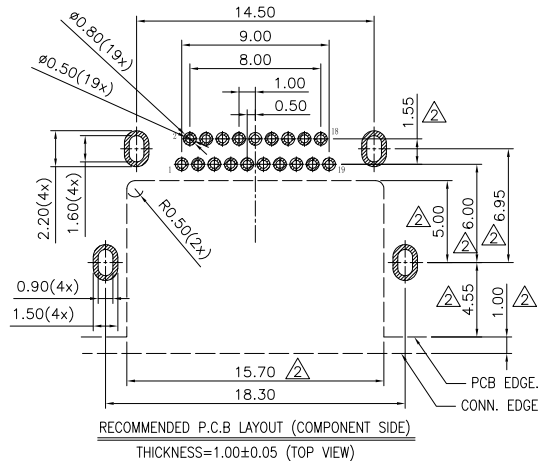
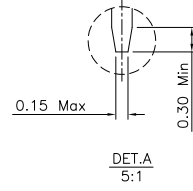
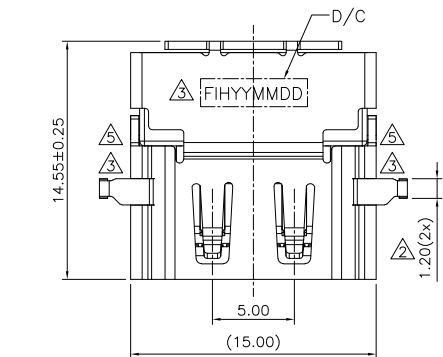

- NOTE:
- MATERIAL:
    - HOUSING: LCP+30%G.F,UL94V-0, COLOR:BLACK.
    - CONTACT: COPPER ALLOY, C5191-H
    - SHELL: SK7
  - FINISH:
    - CONTACT: Gold (SEE TABLE) Plating On Contact Area  
100u" Min. Tin Plating On Solertails  
50u" Min. Nickel Underplating Over All
    - SHELL: 50u" Min. Nickell Underplating Over All.

TABLE

FIH P/N	TABLE A GOLD PLATING THICKNESS
A0828-0005	Au 5u"
A0828-0003	Au 30u"
A0828-0001	G/F

PRODUCT SPECIFICATION: DOC.No: SP-AXXX-001	SCALE 1 : 1	DESIGN UNITS mm
TEST REPORT DOC.No: TR-AXXX-001	DRAWN Allen	DATE 2020/07/24
GENERAL TOLERANCES (UNLESS SPECIFIED)	CHECKED	DATE
X.XXX ± 0.10	APPROVED	DATE
X.XX ± 0.25		
X.X ± 0.38		
ANGULAR ± 3°		
THIRD ANGLE PROJECTION	DWG NO. SA0828-001	

FULLINHOPE Technology, LTD.		
TITLE HDMI A TYPE FEMALE REVERSE, SINKING,C/H=-1.07mm		
PART NO. TABLE A	DWG REV. 08	SHEET NO. 1 OF 1

REVISION HISTORY			
REV	DESCRIPTION	Drawing	DATE
04	修改載帶厚度	Allen	2021/03/03

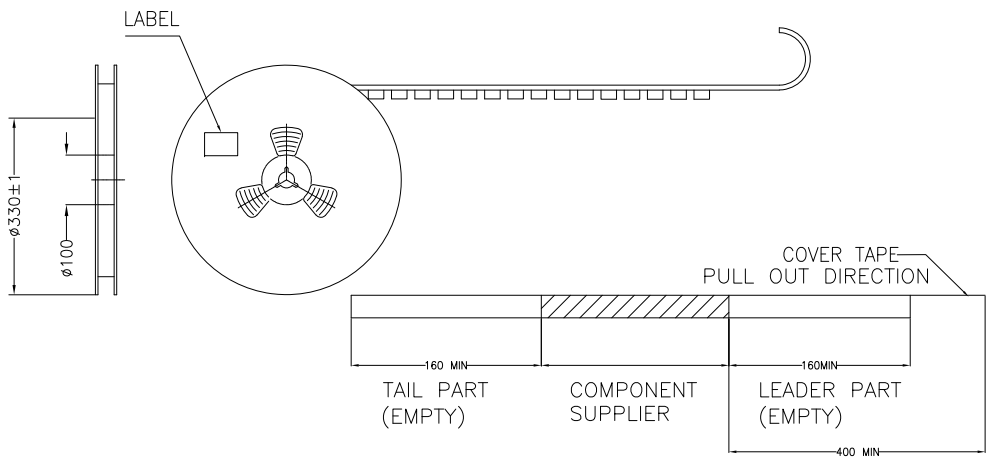
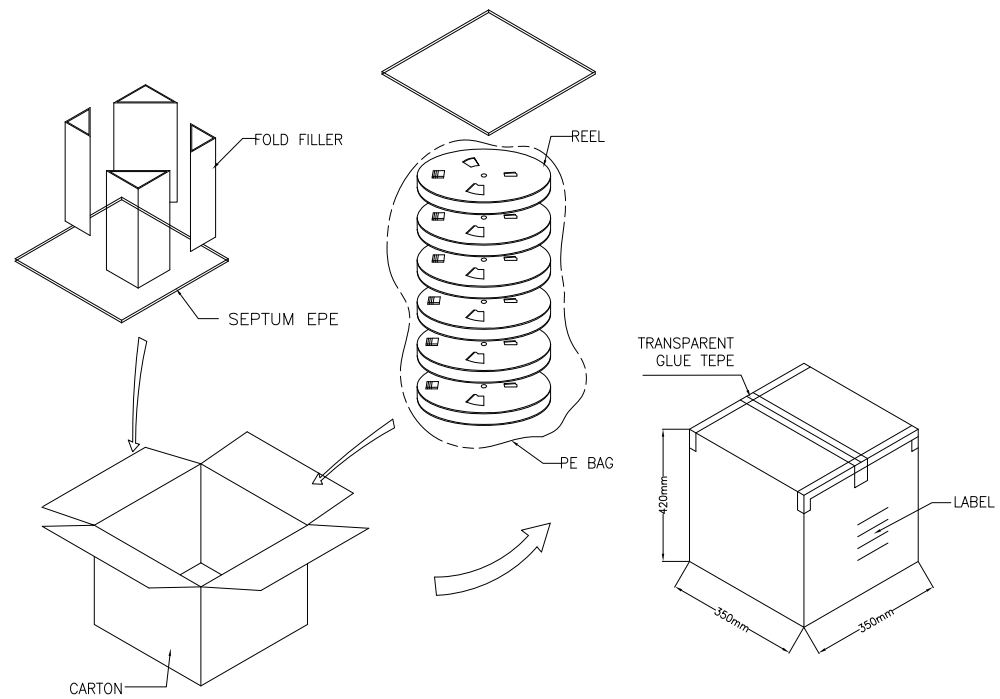
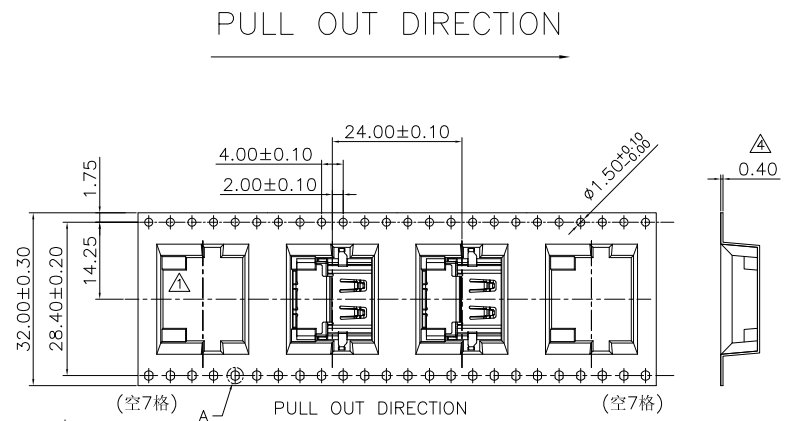

1.COVER TAPE PEELING FORCE:

A	15°~ 0°
F	0.1N~1.3N

PEELING SPEED 300MM/MIN

2.PART DIMENSIONS MEET EIA-481-D REQUIREMENT

PRODUCT P/N	PARTS PER SHIPPING CARTON	PARTS PER REEL	LOADED REEL PER SHIPPING CARTON
A0828-0005	3500	350	10
A0828-0003			
A0828-0001			

PRODUCT SPECIFICATION: DOC.No: SP-AXXXX-001	SCALE 1 : 1	DESIGN UNITS mm	FULLINHOPE Technology, LTD.	
TEST REPORT DOC.No: TR-AXXXX-001	DRAWN Allen	DATE 2020/09/11	TITLE  HDMI A TYPE FEMALE REVERSE, SINKING,C/H=-1.07mm	
GENERAL TOLERANCES (UNLESS SPECIFIED)	CHECKED	DATE		
X.XXX ± 0.20	APPROVED	DATE		
X.XX ± 0.20				
X.X ± 0.25				
ANGULAR ± 3°				
THIRD ANGLE PROJECTION	DWG NO. PA0828-001	PART NO. SEE TABLE	DWG REV. 04	SHEET NO. 1 OF 1